

ALLDAY  
& MILLER



Cardington Square, Hounslow, TW4 6AJ  
£600,000

 4  2  2  E



## Cardington Square, Hounslow, TW4 6AJ

**£600,000**

- Four Bedrooms
- No Onward Chain
- Private Garden
- Freehold
- Ideal For Investors
- Separate Two Bedroom Annexe
- Ground Floor WC
- Driveway
- Close To Piccadilly Line Tube Station
- Good Transport Links

## Description

Perfect for the growing family or Investors is this extended four bedroom semi-detached property with a separate annexe to the rear.

This family home presented to the market comprises of a welcoming entrance hall, spacious reception lounge, downstairs WC, family room flowing into the fully fitted kitchen and dining room which gives access to the rear garden.

Rising to the first floor offers three double bedrooms ( master with fitted wardrobes ) and a family bathroom suite.

To the front a paved driveway creating space for off street parking. To the rear a private garden mainly laid to lawn with an outbuilding ideal for extra storage space.

## Situation

Cardington Square a popular residential road in the heart of Hounslow. Hatton Cross station being just a short drive away, also the M25/M4 motorway close by giving easy links to central London and the surrounding. Feltham town centre within close proximity with a variety of local shops, restaurants, cafes and fitness facilities. A number of high regarded schools in the local area including Beavers Community Primary School just opposite.



## Floor Plans

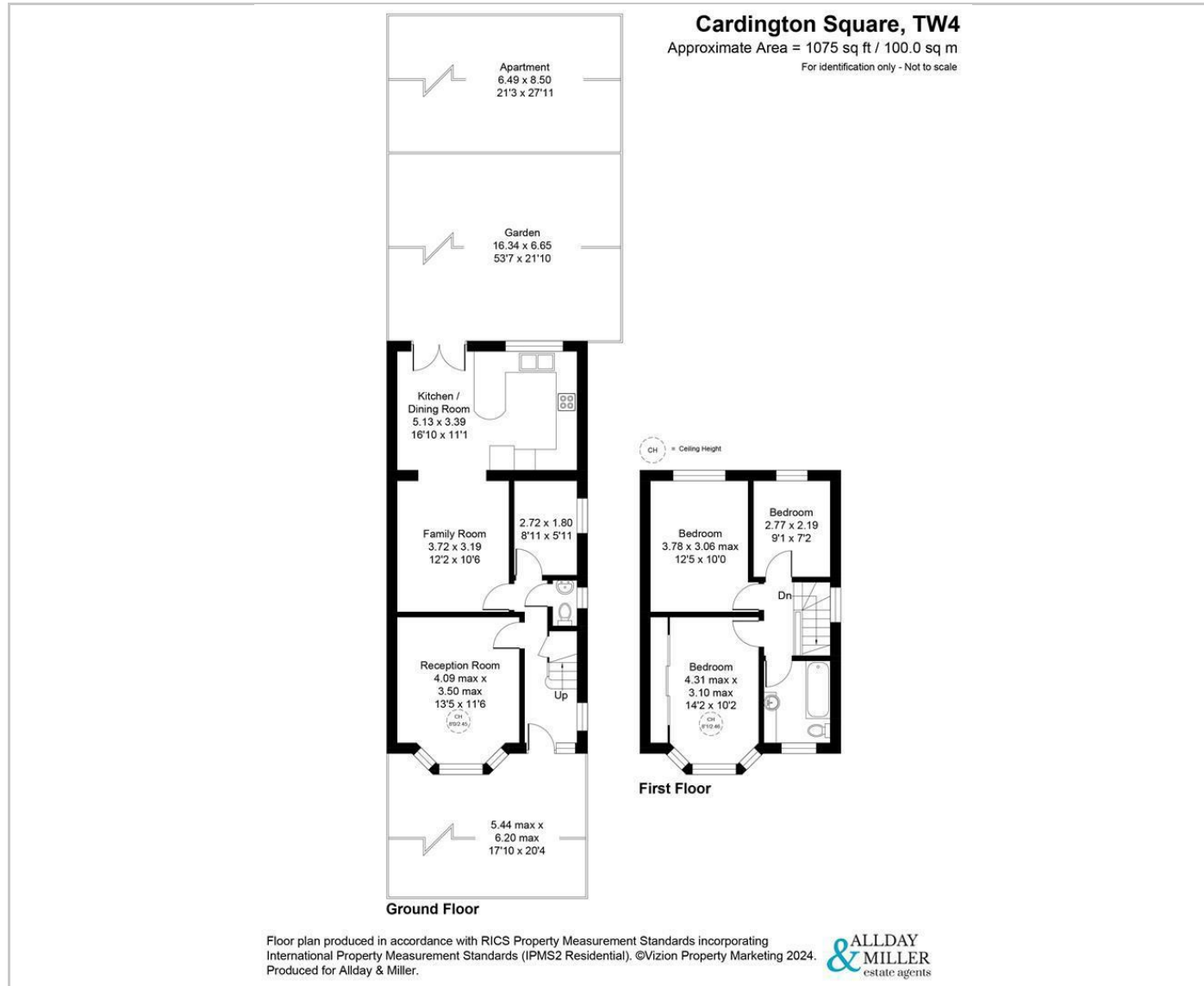

## Area Map

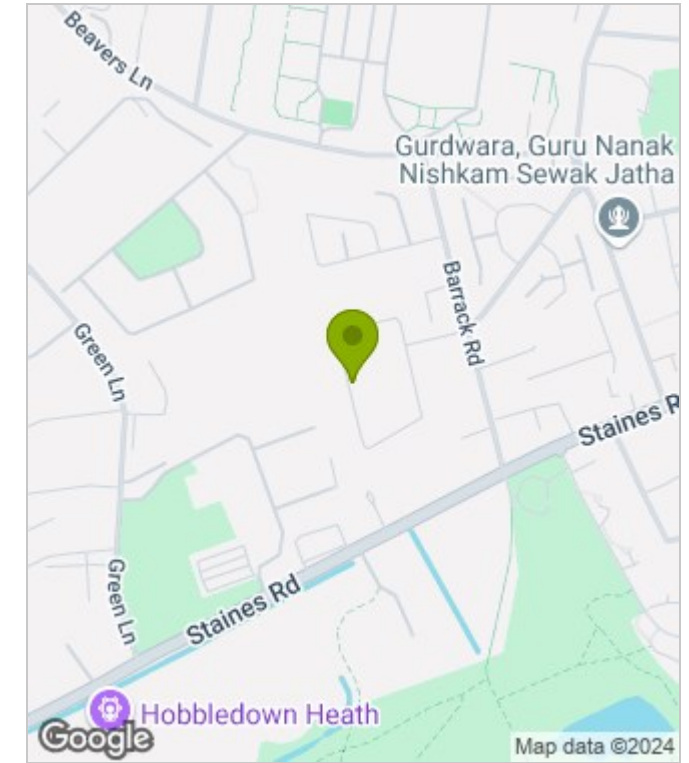

## Energy Performance Graph

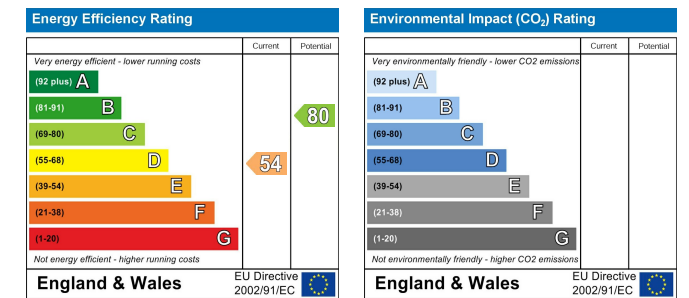

These particulars, whilst believed to be accurate are set out as a general outline only for guidance and do not constitute any part of an offer or contract. Intending purchasers should not rely on them as statements of representation of fact, but must satisfy themselves by inspection or otherwise as to their accuracy. No person in this firm's employment has the authority to make or give any representation or warranty in respect of the property.